



markacivata makine

bağlantı elemanları

"GÜÇLÜ ÇÖZÜM ORTAĞINIZ"

JERN YAO

Innovation, Quality & Price ,provides the high quality and superior services.



JERN YAO

Innovation, Quality & Price
Provides the high quality and superior services.



SATIŞ VE PAZARLAMA MÜDÜRÜ

Tolga KARANFİL

+90 546 778 78 35

info@markacivatamakine.com

MARKA CİVATA VE BAĞLANTI ELEMANLARI

Şekerpınar Mahallesi Fevzi Çakmak
Caddesi, Başak Sokak, Marmara Geri Dönüşümcüler
Sanayi Sitesi No:22/B Çayırova / KOCAELİ / TÜRKİYE



/markacivata



markacivatamakine
bağlantı elemanları

hakkımızda



Marka Cıvata Bağlantı Elemanları Sanayi, 2008 yılında Hüseyin KURMUT ve Hasan KURMUT tarafından Bayrampaşa'da 100 m²'lik bir atölyede kurulmuştur. Sürekli gelişme ve yenilenme vizyonu ile bugün Şekerpınar / Kocaeli bölgesinde bulunan 1500 m²'lik kapalı alana sahip işletmesi ile aylık 170 ton üretim kapasitesine sahiptir. Cıvata, somun, vida, pul vb. bağlantı elemanları üretiminin yanı sıra müşterilerinin önemli hırdavat malzemeleri ihtiyaçlarının karşılanması konusunda da faaliyetlerini sürdürmektedir.

Konusunda uzman bir kadroya sahip olan firmamız, teknolojik gelişmelere paralel olarak, sürekli yenilenen makine ekipmanlarıyla, gelişen teknolojik yenilikleri araştırıp, eğitime önem vererek, bilinçli bir sorumluluk anlayışı ile hizmet vermektedir. Hizmetin teknoloji üzerinde yoğunlaşmasına önem veren firmamız, müşteri odaklı hizmet anlayışını hedef alarak, sektöründeki uzun yıllara dayanan deneyimi ve referansları ile Türkiye'nin önde gelen firmaları arasında yerini almıştır. Soğuk şekillendirme imalatında uzman kadrosu ile 2025 yılı itibari ile sektöründe dünyanın en önde gelen Tayvan firması Jern Yao ile Türkiye satış bayiliği konusunda anlaşma sağlanmıştır. Uzman kadromuz bizzat yerinde Jern Yao'nun Tayvan fabrikasında uzun süreli makine kurulum, makine bakım, ürün tasarım, ürün imalat konularında eğitimler almıştır. Bağlantı elemanları makinelerinin yenilenen teknolojisine yön veren Jern Yao, avrupanın parlayan yıldızı ülkemizin potansiyeline büyük önem vermektedir. Kaliteden ödün vermeyenlerin bir numaralı adresi durumundadır. Makine ekipmanlarının uzun ömrü ve hassas üretim parametreleri ile müşterilerinin vazgeçilmezi olmuştur. 2025 Yılından itibaren Jern Yao firması ile siz müşterilerimizin her türlü soru ve görüşlerini cevaplamaktan mutluluk duyacağız.



markacivata makine
baęlantı elemanları

hizmetlerimiz

MARKA CİVATA OLARAK MAKİNE HİZMETLERİMİZ

- İmalatını yapacağınız ürün için makine seçimi yapmadıysanız, sizin için teknik ekibimiz ve Tayvan'lı mühendisler ile ürününüze uygun doğru makine seçimi yapıyoruz.
- Seçili makinenin tüm ekipman bilgilerini, marka ve kalitelerini sizlerle paylaşıyoruz.
- Sizin yada bizim tarafımızdan seçilmiş olan makinenizin imalat durumunu, güncellemelerini her hafta sizlerle rapor olarak paylaşıyoruz.
- Makine hazır olduğunda ister canlı, ister video ile makinenin son durumunu sizlere aktarıyoruz.
- Makine ile birlikte istemiş olduğunuz ürüne ait kalıp seti hazırlanıyor.
- Makineye bağlanan kalıp seti ile birlikte ürününüzün çalışır halini sizlere video ile birlikte aktarıyoruz.
- Opsiyonel olarak makinenizin kurulumunu Jern Yao mühendisleri yada biz yapıyoruz. Kurulum sonrası makine eğitimi, makine operatörü eğitimi veriyoruz. (Ücrete tabi)
- Opsiyonel olarak kurulum sonrası ilk ürün ayarınızı yapıyor ve ilk 1.000 Adet ürün imalatını Jern Yao mühendisleri yada biz yapıyoruz. Ürüne ait kalıp ve teknik detaylar hakkında eğitim veriyoruz. (Ücrete taabi)
- Opsiyonel olarak makinenizin altı aylık periyotlarla belirlenen bakımlarını tamamen biz yapıyoruz. Makine bakım periyotları, değişim parçaları, bakım ekipmanları sizlerle paylaşılıyor. Bakım zamanı geldiğinde tarafımızca tüm bakımları üstleniliyor. (Ücrete taabi)

5 YIL GARANTİ KAPSAMI

- Makine kurulumu ve tüm bakımları tarafımızca yapılan makinelere beş yıllık garanti veriyoruz. Garanti kapsamında gerekli değişim parçaları tarafımızca ücretsiz bir şekilde değiştiriliyor ve testleri yapılarak makine yeniden devreye alınıyor.
- Beklenmeyen yada kullanıcı kaynaklı arıza durumlarında aynı gün online destek garantisi veriyoruz. Online destek ile giderilemeyen problemlerde üç gün içinde arıza tespit personeli gönderiyoruz. Yaşanan probleme bağlı olarak en hızlı aksiyonla onarım garantisi veriyoruz. (Ücrete taabi)
- Söz konusu opsiyonel konu başlıklarının fiyatları makine ve lokasyona bağlı olarak değişkenlik gösterebilmektedir. Makine teklifiniz ile birlikte bu opsiyonlarda sizinle paylaşılacaktır.
- İstedığınız herhangi başka bir makine içinde Tayvan'lı iş ortaklarımızın referans olabileceği makineler içinde tekliflerimizi sunmaktan memnuniyet duyarız.





markacivatamakine
baęlantı elemanları

makine çeşitlerimiz

TRANSFERLİ CIVATA PRESLERİMİZ



TRANSFERLİ SOMUN PRESLERİ



ÇİFT VURUŞ VİDA PRESLERİ



ÇEŞİTLİ OVALAMA MAKİNELERİ





markacivatamakine
baęlantı elemanları

makine çeşitlerimiz

ÇEŞİTLİ KILAVUZ MAKİNELERİ



SANTRİFÜJ MAKİNELERİ



makine çeşitlerimiz



markacivatamakine
bağlantı elemanları

KALİTE AYIKLAMA MASALARI



KONVEYÖRLER





markacivatamakine
baęlantı elemanları

sarf malzeme

SARF MALZEME

Civata, vida, somun gibi baęlantı elemanlarının imalatında kullanılan bir ok sarf malzeme stoklarımızda yer almaktadır. Stoklarımızda olmayan sarf malzemeler iin en hızlı teslimat ile mşterilerimize özüm ortaęı oluyoruz.

Destek Sunduęumuz Sarflar;

- Yıldızlar
- Soketler
- Punchlar
- Ejektörler
- Kalıp elmasları
- Transfer parmakları
- Mühreler
- Tel makasları
- Punch pensleri
- Ovalama top ve tarakları
- Kılavuzlar
- Kalıp seti imatları



YILDIZLAR



KILAVUZLAR



**SOMUN CIVATA VE
VİDA KALIPLARI**



PUNCH VE EJEKTÖRLER



KILAVUZLAR



OVALAMA TARAK VE TOPLARI

PERSONEL EĞİTİM MERKEZİ

Uzman kadromuz ile yeni işe başlayacak yada yeni işe başlamış personelinize teorik ve pratik eğitimler veriyoruz. Teorik eğitim ile personeliniz cıvata tarihinden, teknik resim okuma ve lot takibine kadar bir çok konu hakkında kalıcı bilgiye sahip oluyor. Pratik eğitim ile Şekerpınar / Kocaeli bölgesinde bulunan fabrikamızda ihtiyacınıza yönelik olarak makine eğitimleri alıyor. Pratik eğitim konuları sizler tarafından belirleniyor.

- Transferli somun presleri,
- Transferli cıvata presleri,
- Çift vuruş vida presleri,
- Tarak yada üç top ovalama makineleri,
- Flanşlı, servo yada dört kafa kılavuz makineleri,
- Üretim kalite takip süreçleri.

Personeliniz eğitim konusuna bağlı olarak değişen eğitim süresi sonunda üretiminize hızlıca adapte olarak sizlere değer katıyor. Şehir dışından gelecek personelleriniz için anlaşmalı otellerimizde konaklama sağlıyor, servislerini kendimiz karşılıyoruz.

Personel sayısına bağlı olmak üzere eğitmen kadromuz sizlere kendi lokasyonunuzda da destek olabiliyor.

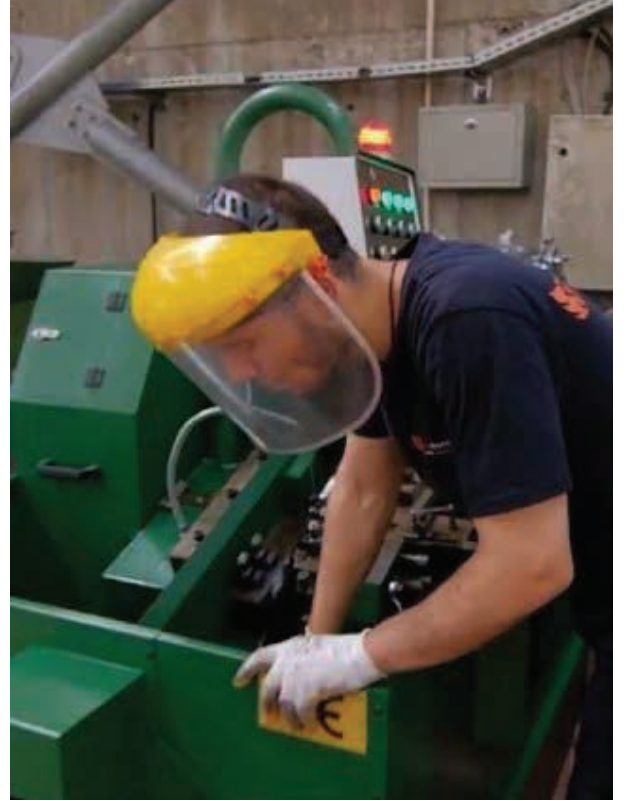

KALIP TASARIM EĞİTİMİ (BAŞLANGIÇ SEVİYE)

Uzman kalıp tasarımcılarımız eşliğinde personelinize tasarım programlarında çizim eğitimi veriyoruz. Öncelikli olarak basit çizim eğitimleri ile tasarım programının kullanımını kavramanız sağlıyoruz. Sonrasında basit ürünlere ait örnek kalıp tasarımlarını çalışıyoruz. Kalıp tasarımındaki incelikleri, kullanılacak malzemeleri, malzeme sertliklerini, dayanımlarını anlatıyoruz. Sonrasında bir çok basit ve kompleks ürüne ait kalıpları birlikte tasarlıyoruz ve pratik yapıyoruz.

Personeliniz eğitim konusuna bağlı olarak değişen eğitim süresi sonunda ürün kalıplarınıza hızlıca adapte olarak sizlere değer katıyor. Şehir dışından gelecek personelleriniz için anlaşmalı otellerimizde konaklama sağlıyor, servislerini kendimiz karşılıyoruz.

Personel sayısına bağlı olmak üzere eğitmen kadromuz sizlere kendi lokasyonunuzda da destek olabiliyor.

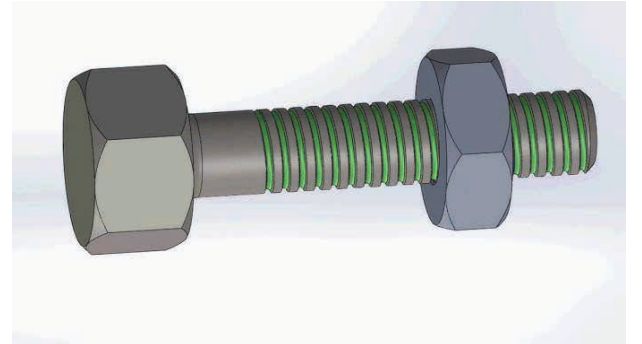

SPECIFICATION規格/機型		MODEL	JBF 7B2S	JBF 10B2S	JBF 10B2SL	JBF 10B2SXL	JBF 13B2S	JBF 13B2SL	JBF 17B2S	JBF 17B2SL	JBF 19B2S	JBF 19B2SL	JBF 24B2S	JBF 30B2S
FORGING STATION 模數			2											
CUT-OFF DIA. MAX. 最大切斷直徑 (mm)			5	8			10		12		15		18	23
CUT-OFF LENGTH 切斷長度 (mm)			15~55	20~70	28~105	28~120	24~94	30~130	28~105	42~180	35~140	55~185	43~185	63~270
KICK-OUT LENGTH MAX. 後托頂出長度 (mm)			45	60	90	115	76	120	90	175	120	180	185	230
PK.O. LENGTH MAX. 前托頂出長度 (mm)			10	12	20	22	17	23	20	30	27	30	33	35
CUT-OFF QUILL (DxL) 切模 (mm)			20x30	28x46			35x56	38x79	40x66	40x80	46x80	46x80	60x100	75x120
MAIN DIE HOLE (DxL) 母模 (mm)			38x60	50x65	50x105	50x123	60x85	70x135	70x95	80x185	80x123	93x190	100x195	125x240
DIES PITCH 母模中心距離 (mm)			48	60			87		93		114		126	138
PUNCH HOLE (DxL) 公模束 (mm)			32x60	40x82	40x110	40x110	45x90	45x111	50x103	50x133	60x120	60x170	70x160	90x197
RAM STROKE 主滑板行程 (mm)			100	120	150	180	140	200	160	250	200	270	280	360
FORGING POWER 壓造力 (ton)			12	25	25	25	40	45	55	55	70	70	130	185
PRODUCTS 產品	SIZE 尺寸		3/16(M4)	1/4(M6)			5/16(M8)		3/8(M10)		1/2(M12)		5/8(M16)	3/4(M20)
	MAX.L 最長長度 (mm)		40	50	75	100	65	100	75	150	100	150	150	200
	MIN.L 最短長度 (mm)		10	12	20	20	14	20	16	30	20	40	25	40
	OPEN UPSET DIA. 頭部最大鍛粗直徑 (mm)		Φ12.5	Φ15			Φ20		Φ21		Φ31		Φ32	Φ32
MAX. OUTPUT 每分鐘最大產能 (pcs/minute)			300	300	240	210	240	210	210	175	170	135	120	100
MAIN MOTOR 主馬達 (hp)			7.5	10	10	10	15	15	15	20	30	30	60	100
APPROX. WT. 機械重量 (ton)			3	6	6.8	7.6	8	10	11.5	15	19	22	35	50

DSC01-0526-2017

- WE RESERVE THE RIGHT TO CHANGE THE DESIGNS & SPECIFICATIONS WITHOUT NOTICE (本公司隨時進行研究改進的工作，因此保有隨時更改設計、規格尺寸及機械結構之權利，本目錄僅供參考。)
- PRODUCTION CAPACITY DEPENDS ON APPLICABLE PRODUCTS, MATERIAL, TENSILE STRENGTH OF THE WIRE. (設備產能依產品之型狀、材質及線材抗拉強度而有所差異。)
- THE KICK-OUT STROKE IN BRACKET SHOWS THE MAX. LENGTH OF THE PRODUCT ALLOWED FOR ROTATIONAL TRANSFER. (後托頂出長度括弧內之數據表示壓造過程中翻轉產品的最長長度)

2

SPECIFICATION規格/機型		MODEL	JBF 7B3S	JBF 10B3S	JBF 10B3SL	JBF 10B3SXL	JBF 13B3S	JBF 13B3SL	JBF 13B3SXL	JBF 17B3S	JBF 17B3SL	JBF 17B3SXL	JBF 17B3SUL	
FORGING STATION 模數			3											
CUT-OFF DIA. MAX. 最大切斷直徑 (mm)			5	8			10			12				
CUT-OFF LENGTH 切斷長度 (mm)			15~55	20~70	24~105	28~125	24~94	30~130	40~180	28~105	42~180	62~230	112~350	
KICK-OUT LENGTH MAX. 後托頂出長度 (mm)			45	60	90	115	76	120	175	90	175	225	325	
PK.O. LENGTH MAX. 前托頂出長度 (mm)			10	13	20	22	17	23	30	20	30	36	60	
CUT-OFF QUILL (DxL) 切模 (mm)			20x30	28x46	28x46	28x46	35x56	38x79	38x79	40x66	40x80	40x80	40x80	
MAIN DIE HOLE (DxL) 母模 (mm)			38x60	50x65	50x105	50x123	60x85	70x135	70x185	70x95	80x185	80x240	80x330	
DIES PITCH 母模中心距離 (mm)			48	60			87			93				
PUNCH HOLE (DxL) 公模束 (mm)			32x60	40x82	40x110	40x110	45x90	45x111	45x130	50x103	50x133	50x190	50x200	
RAM STROKE 主滑板行程 (mm)			100	120	150	200	140	200	250	160	250	360	460	
FORGING POWER 壓造力 (ton)			15	28	30	35	50	50	55	70	70	80	80	
PRODUCTS 產品	SIZE 尺寸		3/16(M4)	1/4(M6)			5/16(M8)			3/8(M10)				
	MAX.L 最長長度 (mm)		40	50	75	100	65	100	150	75	150	200	300	
	MIN.L 最短長度 (mm)	HEX. 外六角螺絲		10	12	16	20	14	20	30	16	30	50	100
		SOCKET 強力螺絲		12	16	20	25	20	25	40	20	40	50	100
OPEN UPSET DIA. 頭部最大鍛粗直徑 (mm)		Φ12.5	Φ15			Φ20			Φ21					
MAX. OUTPUT 每分鐘最大產能 (pcs/minute)			300	300	240	210	240	210	180	210	175	110	80	
MAIN MOTOR 主馬達 (hp)			7.5	10	15	15	15	20	30	20	30	40	40	
APPROX. WT. 機械重量 (ton)			3.5	6.5	7.8	9	10	11.5	14	14	18	21	26.5	

P3-1

DSC02-0526-2017

- WE RESERVE THE RIGHT TO CHANGE THE DESIGNS & SPECIFICATIONS WITHOUT NOTICE (本公司隨時進行研究改進的工作，因此保有隨時更改設計、規格尺寸及機械結構之權利，本目錄僅供參考。)
- PRODUCTION CAPACITY DEPENDS ON APPLICABLE PRODUCTS, MATERIAL, TENSILE STRENGTH OF THE WIRE. (設備產能依產品之型狀、材質及線材抗拉強度而有所差異。)
- THE KICK-OUT STROKE IN BRACKET SHOWS THE MAX. LENGTH OF THE PRODUCT ALLOWED FOR ROTATIONAL TRANSFER. (後托頂出長度括弧內之數據表示壓造過程中翻轉產品的最長長度)

3

JBF SERIES 3-DIE 3-BLOW BOLT FORMER (三模三沖螺絲成型機)

SPECIFICATION 規格/機型	MODEL	JBF 19B3S	JBF 19B3SL	JBF 19B3SXL	JBF 19B3SUL	JBF 24B3S	JBF 24B3SL	JBF 24B3SXL	JBF 24B3SUL	JBF 30B3S	JBF 30B3SL	JBF 30B3SUL	JBF 33B3S	
FORGING STATION 模數		3												
CUT-OFF DIA. MAX. 最大切斷直徑 (mm)		15				18				23			26	
CUT-OFF LENGTH 切斷長度 (mm)		35~140	55~185	65~240	115~370	43~185	68~270	78~320	118~370	63~270	83~320	123~370	76~300	
KICK-OUT LENGTH MAX. 後托頂出長度 (mm)		120	180	225	325	185	230	280	335	230	285	335	260	
PK.O. LENGTH MAX. 前托頂出長度 (mm)		26	30	35	60	33	36	50	60	35	60	60	45	
CUT-OFF QUILL (DxL) 切模 (mm)		46x80	46x80	60x100	65x100	60x100	60x120	60x120	60x120	75x120	75x120	75x120	84x130	
MAIN DIE HOLE (DxL) 母模 (mm)		80x123	93x190	93x240	93x350	100x195	100x240	100x294	100x360	125x240	125x294	125x370	140x280	
DIES PITCH 母模中心距離 (mm)		114				126				138			156	
PUNCH HOLE (DxL) 公模束 (mm)		60x120	60x170	60x200	60x250	75x160	75x200	75x232	75x232	90x197	90x232	90x240	96x210	
RAM STROKE 主滑板行程 (mm)		200	270	360	500	280	360	420	500	360	430	500	400	
FORGING POWER 壓進力 (ton)		90	90	100	100	160	160	175	175	220	235	250	260	
PRODUCTS 產品	SIZE 尺寸	1/2 (M12)				5/8 (M16)				3/4 (M20)			7/8 (M22)	
	MAX.L 最長長度 (mm)	100	150	200	300	150	200	250	300	200	250	300	225	
	MIN.L (mm) 最短長度	HEX. 外六角螺絲	20	40	50	100	25	50	60	100	40	60	60	50
		SOCKET 強力螺絲	25	40	50	100	35	50	60	100	60	60	60	60
OPEN UPSET DIA. 頭部最大鍛粗直徑 (mm)	Φ 31				Φ 32				Φ 32			--		
MAX. OUTPUT 每分鐘最大產能 (pcs/minute)		170	135	110	80	120	100	85	80	100	80	75	75	
MAIN MOTOR 主馬達 (hp)		40	50	50	50	75	75	100	100	100	100	100	125	
APPROX. WT. 機械重量 (ton)		22	25	29	36	40	44	49	54	57	63	69	75	

P3-2

DSC02-0526-2017

- WE RESERVE THE RIGHT TO CHANGE THE DESIGNS & SPECIFICATIONS WITHOUT NOTICE (本公司隨時進行研究改進的工作，因此保有隨時更改設計、規格尺寸及機械結構之權利，本目錄僅供參考。)
- PRODUCTION CAPACITY DEPENDS ON APPLICABLE PRODUCTS, MATERIAL, TENSILE STRENGTH OF THE WIRE. (設備產能依產品之型狀、材質及線材抗拉強度而有所差異。)
- THE KICK-OUT STROKE IN BRACKET SHOWS THE MAX. LENGTH OF THE PRODUCT ALLOWED FOR ROTATIONAL TRANSFER. (後托頂出長度括弧內之數據表示壓進過程中翻轉產品的最長長度)

JBF SERIES 3-DIE 3-BLOW BOLT FORMER (三模三沖螺絲成型機)

SPECIFICATION 規格/機型	MODEL	JBF 36B3SS	JBF 36B3S	JBF 41B3S	JBF 45B3S									
FORGING STATION 模數		3												
CUT-OFF DIA. MAX. 最大切斷直徑 (mm)		29		34	38									
CUT-OFF LENGTH 切斷長度 (mm)		69~220	89~320	114~400	138~450									
KICK-OUT LENGTH MAX. 後托頂出長度 (mm)		185	290	340	390									
PK.O. LENGTH MAX. 前托頂出長度 (mm)		30	60	60	70									
CUT-OFF QUILL (DxL) 切模 (mm)		90x140	90x140	110x140	115x140									
MAIN DIE HOLE (DxL) 母模 (mm)		160x210	160x294	178x385	195x420									
DIES PITCH 母模中心距離 (mm)		174		195	210									
PUNCH HOLE (DxL) 公模束 (mm)		105x180	105x232	120x250	135x280									
RAM STROKE 主滑板行程 (mm)		300	440	500	580									
FORGING POWER 壓進力 (ton)		320	320	450	600									
PRODUCTS 產品	SIZE 尺寸	1 (M24)		1 & 1/8 (M27)	1 & 1/4 (M30)									
	MAX.L 最長長度 (mm)	150	250	300	355									
	MIN.L (mm) 最短長度	HEX. 外六角螺絲	40	60	80	100								
		SOCKET 強力螺絲	50	60	80	100								
OPEN UPSET DIA. 頭部最大鍛粗直徑 (mm)	Φ 58		--	Φ 62										
MAX. OUTPUT 每分鐘最大產能 (pcs/minute)		85	70	55	45									
MAIN MOTOR 主馬達 (hp)		125	125	150	175									
APPROX. WT. 機械重量 (ton)		78	92	134	167									

P3-3

DSC02-0526-2017

- WE RESERVE THE RIGHT TO CHANGE THE DESIGNS & SPECIFICATIONS WITHOUT NOTICE (本公司隨時進行研究改進的工作，因此保有隨時更改設計、規格尺寸及機械結構之權利，本目錄僅供參考。)
- PRODUCTION CAPACITY DEPENDS ON APPLICABLE PRODUCTS, MATERIAL, TENSILE STRENGTH OF THE WIRE. (設備產能依產品之型狀、材質及線材抗拉強度而有所差異。)
- THE KICK-OUT STROKE IN BRACKET SHOWS THE MAX. LENGTH OF THE PRODUCT ALLOWED FOR ROTATIONAL TRANSFER. (後托頂出長度括弧內之數據表示壓進過程中翻轉產品的最長長度)

JBF SERIES 4-DIE 4-BLOW BOLT FORMER (四模四冲螺絲成型機)

SPECIFICATION規格/機型	MODEL	JBF 5B4S	JBF 7B4S	JBF 7B4SXL	JBF 10B4S	JBF 10B4SL	JBF 13B4S	JBF 13B4SL	JBF 13B4SXL	JBF 13B4SUL	JBF 17B4S	JBF 17B4SL	JBF 17B4SXL	JBF 17B4SUL	JBF 19B4S	JBF 19B4SL	JBF 19B4SXL	JBF 19B4SLL	JBF 19B4SUL	JBF 19B4SULL					
FORGING STATION 模數		4																							
CUT-OFF DIA.MAX 最大切斷直徑 (mm)		3				5				8				10				12				15			
CUT-OFF LENGTH.切斷長度 (mm)		11~35	15~55	17~80	20~70	24~105	26~105	30~130	40~180	50~220	28~135	42~180	62~230	112~350	35~140	55~185	65~240	65~310	115~370	115~470					
KICK-OUT LENGTH.MAX後托頂出長度 (mm)		32	45	75	60	90	90	120	175	215	115	175	225	325	120	180	225	280	325	430					
P.K.O.LENGTH.MAX 前托頂出長度 (mm)		8	10	17	13	20	20	23	30	34	20	30	36	60	26	30	35	60	60	70					
CUT-OFF QUILL (DxL) 切模 (mm)		18x25	20x30	20x50	28x46	28x46	35x56	38x79	38x79	38x79	40x66	40x80	40x80	40x80	46x80	46x80	60x100	60x100	65x100	60x100					
MAIN DIE HOLE (DxL) 母模 (mm)		28x45	38x60	38x85	50x65	50x105	60x105	70x135	70x185	70x240	70x135	80x185	80x240	80x330	80x123	93x190	93x240	93x294	93x350	93x450					
DIES PITCH 母模中心距離 (mm)		36			48			60			87				93				114						
PUNCH HOLE (DxL) 公模束 (mm)		24x45	32x60	32x90	40x82	40x110	45x110	45x111	45x130	45x175	50x111	50x133	50x190	50x200	60x120	60x170	60x200	60x232	60x250	60x270					
RAM STROKE 主滑板行程 (mm)		80	100	140	120	150	150	200	250	350	180	250	360	460	200	270	360	420	500	610					
FORGING POWER 壓造力 (ton)		10	20	25	40	40	65	65	70	70	85	85	90	90	120	120	130	130	130	145					
PRODUCTS 產品	SIZE 尺寸	1/8 (M3)		3/16 (M4)			1/4 (M6)			5/16 (M8)				3/8 (M10)				1/2 (M12)							
	MAX.L 最長長度 (mm)	25	40	65	50	75	75	100	150	200	100	150	200	300	100	150	200	250	300	406					
	MINL(mm) 最短長度	HEX. 外六角螺絲	8	10	12	12	16	16	20	30	40	16	30	50	100	20	40	50	50	100	100				
		SOCKET 強力螺絲	10	12	16	16	20	20	25	40	40	20	40	50	100	25	40	50	50	100	100				
OPEN UPSET DIA. 頭部最大鍛粗直徑 (mm)		Φ12.5			Φ15			Φ20				Φ21				Φ31									
MAX.OUTPUT 每分鐘最大產能 (pcs/minute)		250	300	250	300	240	240	210	180	140	200	175	110	80	170	135	110	90	80	50					
MAIN MOTOR 主馬達 (hp)		5	10	15	15	15	20	30	30	30	30	40	40	40	50	50	50	50	50	50					
APPROX. WT. 機械重量 (ton)		3	4.3	6	7.5	9	12.5	14	16.5	20	17	21	24	30	25	29	32.5	36	40	47					

P2-1

DSC03-0526-2017

- WE RESERVE THE RIGHT TO CHANGE THE DESIGNS & SPECIFICATIONS WITHOUT NOTICE(本公司隨時進行研究改進的工作，因此保有隨時更改設計、規格尺寸及機械結構之權利，本目錄僅供參考。)
- PRODUCTION CAPACITY DEPENDS ON APPLICABLE PRODUCTS, MATERIAL, TENSILE STRENGTH OF THE WIRE.(設備產能依產品之型狀、材質及線材抗拉強度而有所差異。)
- THE KICK-OUT STROKE IN BRACKET SHOWS THE MAX. LENGTH OF THE PRODUCT ALLOWED FOR ROTATIONAL TRANSFER. (後托頂出長度括弧內之數據表示壓造過程中翻轉產品的最長長度)

JBF SERIES 4-DIE 4-BLOW BOLT FORMER (四模四冲螺絲成型機)

SPECIFICATION規格/機型	MODEL	JBF 24B4S	JBF 24B4SL	JBF 24B4SXL	JBF 24B4SUL	JBF 24B4SULL	JBF 30B4S	JBF 30B4SL	JBF 30B4SUL	JBF 30B4SULL	JBF 33B4S	JBF 36B4S	JBF 36B4SL	JBF 36B4SXL	JBF 36B4SUL	JBF 41B4S	JBF 45B4S	JBF 50B4S							
FORGING STATION 模數		4																							
CUT-OFF DIA.MAX 最大切斷直徑 (mm)		18						23						26		29				34		38		42	
CUT-OFF LENGTH.切斷長度 (mm)		43~185	68~270	78~320	118~370	118~420	63~270	83~320	123~370	123~425	76~300	69~220	89~320	129~370	129~460	134~400	138~450	152~480							
KICK-OUT LENGTH.MAX後托頂出長度 (mm)		185	230	280	335	380	230	285	335	380	260	185	290	340	410	340	390	415							
P.K.O.LENGTH.MAX 前托頂出長度 (mm)		33	36	50	60	70	35	60	60	70	45	30	60	60	60	60	70	75							
CUT-OFF QUILL (DxL) 切模 (mm)		60x100	60x120	60x120	60x120	60x120	75x 120				84x130		90x 140				110x140		115x140	132x155					
MAIN DIE HOLE (DxL) 母模 (mm)		100x195	100x240	100x294	100x360	100x420	125x240	125x294	125x370	125x420	145x280	160x210	160x294	160x370	160x450	178x385	195x420	205x450							
DIES PITCH 母模中心距離 (mm)		126						138						156		174				195		210		225	
PUNCH HOLE (DxL) 公模束 (mm)		75x160	75x200	75x232	75x232	75x272	90x197	90x232	90x240	90x290	96x210	105x180	105x232	105x235	105x270	120x250	135x280	150x305							
RAM STROKE 主滑板行程 (mm)		280	360	420	500	580	360	430	500	580	400	300	440	500	600	500	580	620							
FORGING POWER 壓造力 (ton)		200	200	215	215	250	265	285	300	320	320	360	380	420	450	520	635	700							
PRODUCTS 產品	SIZE 尺寸	5/8 (M16)						3/4 (M20)						7/8 (M22)		1 (M24)				1&1/8 (M27)		1&1/4 (M30)		1&3/8 (M33)	
	MAX.L 最長長度 (mm)	150	200	250	300	360	200	250	305	360	225	150	250	300	380	300	355	380							
	MINL(mm) 最短長度	HEX. 外六角螺絲	25	50	60	100	100	40	60	100	100	50	40	60	100	100	100	100	110						
		SOCKET 強力螺絲	35	50	60	100	100	60	60	100	100	60	50	60	100	100	100	100	110						
OPEN UPSET DIA. 頭部最大鍛粗直徑 (mm)		Φ32						Φ32						--		Φ58				--		Φ62		--	
MAX.OUTPUT 每分鐘最大產能 (pcs/minute)		120	100	85	80	65	100	80	75	60	75	80	70	60	55	50	45	40							
MAIN MOTOR 主馬達 (hp)		75	75	100	100	100	100	125	125	125	125	125	150	150	175	200	200								
APPROX. WT. 機械重量 (ton)		46	51	56	62	68	67	73	79	88	85	92	109	120	135	150	190	230							

P2-2

DSC03-0526-2017

- WE RESERVE THE RIGHT TO CHANGE THE DESIGNS & SPECIFICATIONS WITHOUT NOTICE(本公司隨時進行研究改進的工作，因此保有隨時更改設計、規格尺寸及機械結構之權利，本目錄僅供參考。)
- PRODUCTION CAPACITY DEPENDS ON APPLICABLE PRODUCTS, MATERIAL, TENSILE STRENGTH OF THE WIRE.(設備產能依產品之型狀、材質及線材抗拉強度而有所差異。)
- THE KICK-OUT STROKE IN BRACKET SHOWS THE MAX. LENGTH OF THE PRODUCT ALLOWED FOR ROTATIONAL TRANSFER. (後托頂出長度括弧內之數據表示壓造過程中翻轉產品的最長長度)

JBF SERIES 5&6 MULTIPLE STATION BOLT FORMER (五&六模多沖螺絲成型機)

SPECIFICATION規格/機型	MODEL	JBF 7B5S	JBF 10B5S	JBF 10B5SL	JBF 13B5S	JBF 13B5SL	JBF 13B5SXL	JBF 13B5SUL	JBF 17B5S	JBF 17B5SL	JBF 17B5SXL	JBF 17B5SL	JBF 19B5S	JBF 19B5SL	JBF 19B5SXL	JBF 19B5SLL	JBF 19B5SUL	JBF 19B5SL	JBF 19B6SL	JBF 19B6SXL	
FORGING STATION模數		5	5	5	5	5	5	5	5	5	6	5	5	5	5	5	5	6	6		
CUT-OFF DIA. MAX. 最大切斷直徑 (mm)		5	8	10				12				15									
CUT-OFF LENGTH 切斷長度 (mm)		15~55	20~70	24~105	26~105	30~130	40~180	50~220	28~135	42~180	62~230	42~180	40~140	55~185	65~240	65~310	115~370	55~185	65~240		
KICK-OUT LENGTH MAX. 後托頂出長度 (mm)		45	60	90	90	120	175	215	115	175	225	175	120	180	225	280	325	180	225		
PK.O. LENGTH MAX. 前托頂出長度 (mm)		10	13	20	20	23	30	34	20	30	36	30	26	30	35	60	60	30	35		
CUT-OFF QUILL (DxL) 切模 (mm)		20x30	28x46	28x46	35x56	38x79	38x79	38x79	40x66	40x80	40x80	40x80	46x80	46x80	60x100	60x100	65x100	46x80	60x100		
MAIN DIE HOLE (DxL) 母模 (mm)		38x60	50x65	50x105	60x105	70x135	70x185	70x240	70x135	80x185	80x240	80x185	80x123	93x190	93x240	93x294	93x350	93x190	93x240		
DIES PITCH母模中心距離 (mm)		48	60	87				93				114									
PUNCH HOLE (DxL) 公模束 (mm)		32x60	40x82	40x110	45x110	45x111	45x130	45x175	50x111	50x133	50x190	50x133	60x120	60x170	60x200	60x232	60x250	60x170	60x200		
RAM STROKE 主滑板行程 (mm)		100	120	150	150	200	250	350	180	250	360	250	200	270	360	420	500	270	360		
FORGING POWER 壓接力 (ton)		25	45	50	80	85	90	90	105	105	110	125	145	160	170	170	175	195	195		
PRODUCTS 產品	SIZE 尺寸	3/16 (M4)	1/4 (M6)			5/16 (M8)				3/8 (M10)				1/2 (M12)							
	MAX.L最長長度 (mm)	40	50	75	75	100	150	200	100	150	200	150	100	150	200	250	300	150	200		
	MIN.L 最短長度	HEX 外六角螺絲	10	12	16	16	20	30	40	16	30	50	30	20	40	50	50	100	40	50	
		SOCKET 強力螺絲	12	16	20	20	25	40	40	20	40	50	40	25	40	50	50	100	40	50	
OPEN UPSET DIA. 頭部最大鍛粗直徑 (mm)	Φ14	Φ15			Φ20				Φ21				Φ31								
MAX. OUTPUT 每分鐘最大產能 (pcs/minute)		240	240	200	200	180	160	120	180	150	120	150	150	135	110	90	70	135	100		
MAIN MOTOR 主馬達 (hp)		10	15	20	30	30	40	40	40	40	50	50	50	75	75	75	50	75			
APPROX. WT. 機械重量 (ton)		5.3	9	11	14.5	17	20	24	20	24	27	27	28	33	38	43	48	37	44		

P2-1

DSC04-0526-2017

- WE RESERVE THE RIGHT TO CHANGE THE DESIGNS & SPECIFICATIONS WITHOUT NOTICE(本公司隨時進行研究改進的工作，因此保有隨時更改設計、規格尺寸及機械結構之權利，本目錄僅供參考。)
- PRODUCTION CAPACITY DEPENDS ON APPLICABLE PRODUCTS, MATERIAL, TENSILE STRENGTH OF THE WIRE.(設備產能依產品之型狀、材質及線材抗拉強度而有所差異。)
- THE KICK-OUT STROKE IN BRACKET SHOWS THE MAX. LENGTH OF THE PRODUCT ALLOWED FOR ROTATIONAL TRANSFER. (後托頂出長度括弧內之數據表示壓造過程中翻轉產品的最長長度)

8

JBF SERIES 5&6 MULTIPLE STATION BOLT FORMER (五&六模多沖螺絲成型機)

SPECIFICATION規格/機型	MODEL	JBF 24B5S	JBF 24B5SL	JBF 24B5SXL	JBF 24B5SUL	JBF 24B5SULL	JBF 30B5S	JBF 30B5SL	JBF 30B5SUL	JBF 33B5S	JBF 36B5SS	JBF 36B5S	JBF 36B5SL	JBF 41B5S	JBF 45B5S	
FORGING STATION模數		5	5	5	5	5	5	5	5	5	5	5	5	5	5	
CUT-OFF DIA. MAX. 最大切斷直徑 (mm)		18				23				26	29			34	38	
CUT-OFF LENGTH 切斷長度 (mm)		43~185	58~270	83~320	118~370	118~420	63~270	83~320	123~370	76~300	69~220	89~320	129~370	134~400	138~450	
KICK-OUT LENGTH MAX. 後托頂出長度 (mm)		185	230	280	335	380	230	285	335	260	185	290	340	340	390	
PK.O. LENGTH MAX. 前托頂出長度 (mm)		33	36	60	60	70	35	60	60	45	30	60	60	60	70	
CUT-OFF QUILL (DxL) 切模 (mm)		60x100	60x120	60x120	60x120	60x120	75x120			84x130	90x120	90x140	90x140	110x140	115x140	
MAIN DIE HOLE (DxL) 母模 (mm)		100x195	100x240	100x294	100x360	100x420	125x240	125x294	125x370	145x280	160x210	160x294	160x370	178x385	195x420	
DIES PITCH母模中心距離 (mm)		126				138				156	174			195	210	
PUNCH HOLE (DxL) 公模束 (mm)		75x160	75x200	75x232	75x232	75x272	90x197	90x232	90x240	96x210	105x180	105x232	105x235	120x250	135x280	
RAM STROKE 主滑板行程 (mm)		280	360	420	500	580	360	430	500	400	300	440	500	500	580	
FORGING POWER 壓接力 (ton)		230	230	250	250	285	320	340	360	350	400	440	440	630	700	
PRODUCTS 產品	SIZE 尺寸	5/8(M16)				3/4(M20)				7/8(M22)	1(M24)			1&1/8 (M27)	1&1/4 (M30)	
	MAX.L最長長度 (mm)	150	200	250	300	360	200	250	305	225	150	250	300	300	355	
	MIN.L 最短長度	HEX 外六角螺絲	25	50	60	100	100	40	60	100	50	40	60	100	100	100
		SOCKET 強力螺絲	35	50	60	100	100	60	60	100	60	50	60	100	100	100
OPEN UPSET DIA. 頭部最大鍛粗直徑 (mm)	Φ32				Φ32				--	Φ58			--	Φ62		
MAX. OUTPUT 每分鐘最大產能 (pcs/minute)		110	100	90	75	65	90	80	70	75	80	70	60	50	45	
MAIN MOTOR 主馬達 (hp)		100	100	100	100	125	125	125	125	125	125	150	150	200	200	
APPROX. WT. 機械重量 (ton)		53	58	63	69	79	77	84	91	97	106	124	138	168	215	

P2-2

DSC04-0526-2017

- WE RESERVE THE RIGHT TO CHANGE THE DESIGNS & SPECIFICATIONS WITHOUT NOTICE(本公司隨時進行研究改進的工作，因此保有隨時更改設計、規格尺寸及機械結構之權利，本目錄僅供參考。)
- PRODUCTION CAPACITY DEPENDS ON APPLICABLE PRODUCTS, MATERIAL, TENSILE STRENGTH OF THE WIRE.(設備產能依產品之型狀、材質及線材抗拉強度而有所差異。)
- THE KICK-OUT STROKE IN BRACKET SHOWS THE MAX. LENGTH OF THE PRODUCT ALLOWED FOR ROTATIONAL TRANSFER. (後托頂出長度括弧內之數據表示壓造過程中翻轉產品的最長長度)

9

JNF SERIES 5&6 STATION NUT FORMER (五&六模螺帽成型機)

SPECIFICATION 規格/機型	MODEL	JNF 8B5S	JNF 8B6S	JNF 10B5S	JNF 10B6S	JNF 13B5S	JNF 13B6S	JNF 14B5S	JNF 14B6S	JNF 17B5S	JNF 17B6S	JNF 19B5S	JNF 19B6S	JNF 24B5S	JNF 24B6S
FORGING STATION 模數		5	6	5	6	5	6	5	6	5	6	5	6	5	6
CUT-OFF DIA. MAX. 最大切斷直徑 (mm)		8		10		13		14		17		19		24	
CUT-OFF LENGTH MAX. 最大切斷長度 (mm)		6		8		10		12		13		14		18	
KICK-OUT LENGTH MAX. 後托頂出長度 (mm)		10		13		15		18		20		25		30	
CUT-OFF QUILL (DxL) 切模 (mm)		37x 45		45x 55		55x 65		62x 75		72x 80		80x 90		100x 110	
MAIN DIE HOLE (DxL) 母模 (mm)		37x 42		45x 46		55x 50		62x 60		72x 65		80x 72		100x 90	
DIES PITCH 母模中心距離 (mm)		37		45		55		62		72		80		100	
PUNCH HOLE (DxL) 公模束 (mm)		25x 58		30x 83		37x 87		42x 100		42x 105		48x 110		60x 135	
RAM STROKE 主滑板行程 (mm)		60		70		70		80		80		90		120	
FORGING POWER 壓造力 (ton)		26	30	40	45	75	85	85	95	110	125	140	165	235	255
PRODUCT 產品	(inch)	#8	#8	#10,1/4	#10,1/4	#12,5/16	#12,5/16	3/8	3/8	3/8	3/8	1/2	1/2	5/8	5/8
	(mm)	M5	M5	M6	M6	M8	M8	M8	M8	M10	M10	M12	M12	M16	M16
MAX. OUTPUT 每分鐘最大產能 (pcs/minute)		360	340	330	310	310	290	280	260	250	235	210	195	160	145
MAIN MOTOR 主馬達 (hp)		10	10	15	15	20	25	30	30	30	30	40	40	50	50
APPROX. WT. 機械重量 (ton)		4	4.6	5	6	6.8	8	8	10	11	13	16	18.5	26	30

P2-1

DSC06-0206-2015

- WE RESERVE THE RIGHT TO CHANGE THE DESIGNS & SPECIFICATIONS WITHOUT NOTICE (本公司隨時進行研究改進的工作，因此保有隨時更改設計、規格尺寸及機械結構之權利，本目錄僅供參考。)
- PRODUCTION CAPACITY DEPENDS ON APPLICABLE PRODUCTS, MATERIAL, TENSILE STRENGTH OF THE WIRE. (設備產能依產品之型狀、材質及線材抗拉強度而有所差異。)
- THE KICK-OUT STROKE IN BRACKET SHOWS THE MAX. LENGTH OF THE PRODUCT ALLOWED FOR ROTATIONAL TRANSFER. (後托頂出長度括弧內之數據表示壓造過程中翻轉產品的最長長度)

10

JNF SERIES 5&6 STATION NUT FORMER (五&六模螺帽成型機)

SPECIFICATION 規格/機型	MODEL	JNF 28B5S	JNF 28B6S	JNF 32B5S	JNF 32B6S	JNF 36B5S	JNF 36B6S	JNF 41B5S	JNF 41B6S						
FORGING STATION 模數		5	6	5	6	5	6	5	6						
CUT-OFF DIA. MAX. 最大切斷直徑 (mm)		28		32		36		41							
CUT-OFF LENGTH MAX. 最大切斷長度 (mm)		24		28		30		40							
KICK-OUT LENGTH MAX. 後托頂出長度 (mm)		35		40		45		55							
CUT-OFF QUILL (DxL) 切模 (mm)		120x 130		140x 150		160x 170		180x 180							
MAIN DIE HOLE (DxL) 母模 (mm)		120x 105		140x 120		160x 136		180x 180							
DIES PITCH 母模中心距離 (mm)		120		140		160		180							
PUNCH HOLE (DxL) 公模束 (mm)		72x 160		84x 180		96x 210		108x 250							
RAM STROKE 主滑板行程 (mm)		140		160		180		200							
FORGING POWER 壓造力 (ton)		300	330	400	440	550	600	700	780						
PRODUCT 產品	(inch)	3/4	3/4	7/8	7/8	1	1	1&1/8	1&1/8						
	(mm)	M18	M18	M22	M22	M24	M24	M27	M27						
MAX. OUTPUT 每分鐘最大產能 (pcs/minute)		140	130	110	100	95	85	75	70						
MAIN MOTOR 主馬達 (hp)		75	75	100	100	125	150	175	175						
APPROX. WT. 機械重量 (ton)		39	44	55	63	75	82	104	115						

P2-2

DSC06-0206-2015

- WE RESERVE THE RIGHT TO CHANGE THE DESIGNS & SPECIFICATIONS WITHOUT NOTICE (本公司隨時進行研究改進的工作，因此保有隨時更改設計、規格尺寸及機械結構之權利，本目錄僅供參考。)
- PRODUCTION CAPACITY DEPENDS ON APPLICABLE PRODUCTS, MATERIAL, TENSILE STRENGTH OF THE WIRE. (設備產能依產品之型狀、材質及線材抗拉強度而有所差異。)
- THE KICK-OUT STROKE IN BRACKET SHOWS THE MAX. LENGTH OF THE PRODUCT ALLOWED FOR ROTATIONAL TRANSFER. (後托頂出長度括弧內之數據表示壓造過程中翻轉產品的最長長度)

11

JNFL SERIES 5&6 STATION LONG STROKE NUT FORMER (五&六模長衝程螺帽成型機)

SPECIFICATION 規格/機型	MODEL	JNF 8B5SL	JNF 8B6SL	JNF 10B5SL	JNF 10B6SL	JNF 13B5SL	JNF 13B6SL	JNF 14B5SL	JNF 14B6SL	JNF 17B5SL	JNF 17B6SL	JNF 19B5SL	JNF 19B6SL	JNF 24B5SL	JNF 24B6SL	JNF 24B6SXL
FORGING STATION 模數		5	6	5	6	5	6	5	6	5	6	5	6	5	6	6
CUT-OFF DIA. MAX. 最大切斷直徑 (mm)		8		10		13		14		17		19		24		
CUT-OFF LENGTH MAX. 最大切斷長度 (mm)		23		25		33		33		35		38		45	45	60
KICK-OUT LENGTH MAX. 後托頂出長度 (mm)		25		30		35		40		40		45		55	55	80
CUT-OFF QUILL (DxL) 切模 (mm)		37x 45		45x 55		55x 65		62x 75		72x 80		80x 90		100x110		
MAIN DIE HOLE (DxL) 母模 (mm)		37x 55		45x 66		55x 80		62x 90		72x 95		80x 110		100x135	100x135	100x180
DIES PITCH 母模中心距離 (mm)		37		45		55		62		72		80		100		
PUNCH HOLE (DxL) 公模夾 (mm)		25x 58		30x 83		37x 87		42x 100		42x 105		48x 110		60x135		
RAM STROKE 主滑板行程 (mm)		80		95		110		120		120		130		190	190	270
FORGING POWER 壓造力 (ton)		30	35	45	50	80	90	90	100	120	130	150	170	245	260	280
PRODUCT 產品	SOCKET WRENCH 扳手套筒 (mm)	φ 8x 16		φ 10x 20		φ 12x 25		φ 14x 28		φ 17x 28		φ 18x 35		φ 24x45	φ 24x45	φ 24x70
	SOCKET SET SCREW 止付螺絲 (mm)	M8x 25		M10x 30		M12x 35		M14x 35		M16x 40		M18x 40		M24x50	M24x50	M24x70
MAX. OUTPUT 每分鐘最大產能 (pcs/minute)		290	270	270	250	225	210	210	200	190	180	170	160	140	130	115
MAIN MOTOR 主馬達 (hp)		10	15	15	20	20	25	30	30	30	40	40	40	50	75	75
APPROX. WT. 機械重量 (ton)		4.6	5.5	6	7	8	9.2	9.5	11.5	12	15	18.5	21	29	33	38

P2-1

DSC07-1223-2016

- WE RESERVE THE RIGHT TO CHANGE THE DESIGNS & SPECIFICATIONS WITHOUT NOTICE(本公司隨時進行研究改進的工作，因此保有隨時更改設計、規格尺寸及機械結構之權利，本目錄僅供參考。)
- PRODUCTION CAPACITY DEPENDS ON APPLICABLE PRODUCTS, MATERIAL, TENSILE STRENGTH OF THE WIRE.(設備產能依產品之型狀、材質及線材抗拉強度而有所差異。)
- THE KICK-OUT STROKE IN BRACKET SHOWS THE MAX. LENGTH OF THE PRODUCT ALLOWED FOR ROTATIONAL TRANSFER. (後托頂出長度括弧內之數據表示壓造過程中翻轉產品的最長長度)

JNFL SERIES 5&6 STATION LONG STROKE NUT FORMER (五&六模長衝程螺帽成型機)

SPECIFICATION 規格/機型	MODEL	JNF 28B5SL	JNF 28B6SL	JNF 32B5SL	JNF 32B6SL	JNF 32B6SXL	JNF 36B5SL	JNF 36B6SL	JNF 38B5SL	JNF 38B6SL	JNF 41B5SL	JNF 41B6SL	JNF 45B5SL	JNF 45B6SL
FORGING STATION 模數		5	6	5	6	6	5	6	5	6	5	6	5	6
CUT-OFF DIA. MAX. 最大切斷直徑 (mm)		28		32			36		38		41		45	
CUT-OFF LENGTH MAX. 最大切斷長度 (mm)		48		50	50	80	60		70		80		90	
KICK-OUT LENGTH MAX. 後托頂出長度 (mm)		60		65	65	90	75		95		105		125	
CUT-OFF QUILL (DxL) 切模 (mm)		120x 130		140x150			160x 165		165x 175		180x 180		195x 195	
MAIN DIE HOLE (DxL) 母模 (mm)		120x 140		140x155	140x155	140x260	160x 200		165x 260		180x 285		195x 345	
DIES PITCH 母模中心距離 (mm)		120		140			160		165		180		195	
PUNCH HOLE (DxL) 公模夾 (mm)		72x 160		84x180			96x 210		102x 250		108x 250		120x 250	
RAM STROKE 主滑板行程 (mm)		210		230	230	300	250		280		300		340	
FORGING POWER 壓造力 (ton)		330	350	440	460	480	550	600	650	700	780	800	850	920
PRODUCT 產品	SOCKET WRENCH 扳手套筒 (mm)	φ 28x 50		φ 32x56	φ 32x56	φ 32x85	φ 36x 70		φ 38x 90		φ 42x90	φ 42x100	φ 46x 120	
	SOCKET SET SCREW 止付螺絲 (mm)	M27x 55		M32x60	M32x60	M32x85								
MAX. OUTPUT 每分鐘最大產能 (pcs/minute)		125	115	90	85	70	75	70	70	65	65	60	55	50
MAIN MOTOR 主馬達 (hp)		75	100	100	100	125	125	150	150	150	200	200	250	300
APPROX. WT. 機械重量 (ton)		42	47	61	69	75	80	89	102	112	114	125	133	148

P2-2

DSC07-1223-2016

- WE RESERVE THE RIGHT TO CHANGE THE DESIGNS & SPECIFICATIONS WITHOUT NOTICE(本公司隨時進行研究改進的工作，因此保有隨時更改設計、規格尺寸及機械結構之權利，本目錄僅供參考。)
- PRODUCTION CAPACITY DEPENDS ON APPLICABLE PRODUCTS, MATERIAL, TENSILE STRENGTH OF THE WIRE.(設備產能依產品之型狀、材質及線材抗拉強度而有所差異。)
- THE KICK-OUT STROKE IN BRACKET SHOWS THE MAX. LENGTH OF THE PRODUCT ALLOWED FOR ROTATIONAL TRANSFER. (後托頂出長度括弧內之數據表示壓造過程中翻轉產品的最長長度)

JNFR SERIES 5&6 STATION NUT FORMER (五&六模螺帽成型機)

SPECIFICATION規格/機型	MODEL	JNFR 8B5S	JNFR 8B6S	JNFR 10B5S	JNFR 10B6S	JNFR 14B5S	JNFR 14B6S	JNFR 17B5S	JNFR 17B6S	JNFR 19B5S	JNFR 19B6S	JNFR 24B5S	JNFR 24B6S
FORGING STATION 模數		5	6	5	6	5	6	5	6	5	6	5	6
CUT-OFF DIA. MAX. 最大切斷直徑 (mm)		8		10		14		17		19		24	
CUT-OFF LENGTH MAX. 最大切斷長度 (mm)		6		8		12		13		14		18	
KICK-OUT LENGTH MAX. 後托頂出長度 (mm)		10		13		18		20		25		30	
P.K.O. LENGTH MAX. 前托頂出長度 (mm)		4		5		7		8		9		12	
CUT-OFF QUILL (DxL) 切模 (mm)		28x 35		38x 45		45x 60		55x 68		65x 75		85x 90	
MAIN DIE HOLE (DxL) 母模 (mm)		37x 42		45x 46		62x 60		72x 65		80x 72		100x 90	
DIES PITCH母模中心距離 (mm)		37		45		62		72		80		100	
PUNCH HOLE (DxL) 公模束 (mm)		25x 58		30x 72		42x 86		42x 90		48x 98		60x 120	
RAM STROKE主滑板行程 (mm)		60		70		80		80		90		120	
FORGING POWER壓造力 (ton)		26	30	40	45	85	95	110	120	140	165	240	250
PRODUCT SIZE產品規格 (mm)		3/16(M5)	3/16(M5)	1/4(M6)	1/4(M6)	3/8(M8)	3/8(M8)	3/8(M10)	3/8(M10)	1/2(M12)	1/2(M12)	5/8(M16)	5/8(M16)
MAX. OUTPUT每分鐘最大產能 (pcs/minute)		450	410	400	380	340	310	300	280	250	235	195	180
MAIN MOTOR主馬達 (hp)		10	10	15	15	30	30	30	30	40	40	50	50
APPROX. WT. 機械重量 (ton)		4.5	5.3	6	7	9.5	11	13	15	17	20	29	33

P2-1

DSC11-0206-2015

- WE RESERVE THE RIGHT TO CHANGE THE DESIGNS & SPECIFICATIONS WITHOUT NOTICE(本公司隨時進行研究改進的工作，因此保有隨時更改設計、規格尺寸及機械結構之權利，本目錄僅供參考。)
- PRODUCTION CAPACITY DEPENDS ON APPLICABLE PRODUCTS, MATERIAL, TENSILE STRENGTH OF THE WIRE.(設備產能依產品之型狀、材質及線材抗拉強度而有所差異。)
- THE KICK-OUT STROKE IN BRACKET SHOWS THE MAX. LENGTH OF THE PRODUCT ALLOWED FOR ROTATIONAL TRANSFER. (後托頂出長度括弧內之數據表示壓造過程中翻轉產品的最長長度)

JNFR SERIES 5&6 STATION NUT FORMER (五&六模螺帽成型機)

SPECIFICATION規格/機型	MODEL	JNFR 28B5S	JNFR 28B6S	JNFR 32B5S	JNFR 32B6S	JNFR 36B5S	JNFR 36B6S	JNFR 41B5S	JNFR 41B6S	JNFR 45B5S	JNFR 45B6S	JNFR 46B5S	
FORGING STATION 模數		5	6	5	6	5	6	5	6	5	6	5	
CUT-OFF DIA. MAX. 最大切斷直徑 (mm)		28		32		36		41		45		46	
CUT-OFF LENGTH MAX. 最大切斷長度 (mm)		24		28		30		40		60		60	
KICK-OUT LENGTH MAX. 後托頂出長度 (mm)		35		40		45		55		60		70	
P.K.O. LENGTH MAX. 前托頂出長度 (mm)		14		16		18		24		26		32	
CUT-OFF QUILL (DxL) 切模 (mm)		94x 100		105x 120		115x 135		132x 155		138x 165		138x165	
MAIN DIE HOLE (DxL) 母模 (mm)		120x 105		140x 120		160x 136		180x 180		195x 240		210x250	
DIES PITCH母模中心距離 (mm)		120		140		160		180		195		210	
PUNCH HOLE (DxL) 公模束 (mm)		72x 140		84x 160		96x 165		108x 250		120x 250		135x250	
RAM STROKE主滑板行程 (mm)		140		190		200		220		240		260	
FORGING POWER壓造力 (ton)		300	320	400	440	550	600	700	780	800	900	900	
PRODUCT SIZE產品規格 (mm)		3/4(M18)	3/4(M18)	7/8(M22)	7/8(M22)	1(M24)	1(M24)	1&1/8 (M27)	1&1/8 (M27)	1&1/4 (M30)	1&1/4 (M30)	1&1/4 (M30)	
MAX. OUTPUT每分鐘最大產能 (pcs/minute)		160	155	120	110	95	85	75	70	60	55	55	
MAIN MOTOR主馬達 (hp)		75	75	100	100	125	150	175	175	200	300	300	
APPROX. WT. 機械重量 (ton)		42	47	58	66	79	88	111	122	130	145	145	

P2-2

DSC11-0206-2015

- WE RESERVE THE RIGHT TO CHANGE THE DESIGNS & SPECIFICATIONS WITHOUT NOTICE(本公司隨時進行研究改進的工作，因此保有隨時更改設計、規格尺寸及機械結構之權利，本目錄僅供參考。)
- PRODUCTION CAPACITY DEPENDS ON APPLICABLE PRODUCTS, MATERIAL, TENSILE STRENGTH OF THE WIRE.(設備產能依產品之型狀、材質及線材抗拉強度而有所差異。)
- THE KICK-OUT STROKE IN BRACKET SHOWS THE MAX. LENGTH OF THE PRODUCT ALLOWED FOR ROTATIONAL TRANSFER. (後托頂出長度括弧內之數據表示壓造過程中翻轉產品的最長長度)

JNFRL SERIES 6 STATION LONG STROKE NUT FORMER (六模長衝程螺帽成型機)

SPECIFICATION規格/機型	MODEL	JNFR 8B6SL	JNFR 10B6SL	JNFR 14B6SL	JNFR 17B6SL	JNFR 19B6SL	JNFR 24B6SL	JNFR 28B6SL	JNFR 32B6SL	JNFR 32B6SXL	JNFR 36B6SL	JNFR 38B6SL	JNFR 41B6SL
FORGING STATION模數		6											
CUT-OFF DIA. MAX. 最大切斷直徑 (mm)		8	10	14	17	19	24	28	32	32	36	38	41
CUT-OFF LENGTH MAX. 最大切斷長度 (mm)		20	25	30	35	40	50	55	65	80	70	75	80
KICK-OUT LENGTH MAX. 後托頂出長度 (mm)		30	38	42	50	58	66	75	85	100	95	100	115
P.K.O. LENGTH MAX. 前托頂出長度 (mm)		8	10	13	14	17	22	26	32	38	38	38	40
CUT-OFF QUILL(DxL) 切模 (mm)		28x35	38x45	45x60	55x68	65x75	85x90	94x100	105x120	105x120	115x135	115x135	132x155
MAIN DIE HOLE(DxL) 母模 (mm)		37x65	45x80	62x100	72x125	80x140	100x160	120x175	140x190	140x240	160x220	165x250	180x280
DIES PITCH母模中心距離 (mm)		37	45	62	72	80	100	120	140	140	160	165	180
PUNCH HOLE(DxL) 公模束 (mm)		25x83	30x89	42x100	42x120	48x135	60x160	72x160	84x180	84x186	96x220	102x250	108x250
RAM STROKE主滑板行程 (mm)		90	100	120	140	165	200	240	260	300	300	310	320
FORGING POWER壓造力 (ton)		35	50	100	125	170	260	340	460	480	600	700	800
PRODUCT SIZE產品規格 (mm)		φ 8x20	φ 10x30	φ 14x35	φ 17x45	φ 20x50	φ 24x55	φ 28x65	φ 32x70	φ 32x85	φ 36x85	φ 38x90	φ 42x100
MAX. OUTPUT每分鐘最大產能 (pcs/minute)		280	265	230	180	160	140	110	80	65	65	55	50
MAIN MOTOR主馬達 (hp)		15	20	30	40	40	75	75	100	125	150	150	200
APPROX. WT. 機械重量 (ton)		6.2	8	12.5	18	23.5	36	51	73	78	96	114	135

DSC12-1223-2016

- WE RESERVE THE RIGHT TO CHANGE THE DESIGNS & SPECIFICATIONS WITHOUT NOTICE(本公司隨時進行研究改進的工作，因此保有隨時更改設計、規格尺寸及機械結構之權利，本目錄僅供參考。)
- PRODUCTION CAPACITY DEPENDS ON APPLICABLE PRODUCTS, MATERIAL, TENSILE STRENGTH OF THE WIRE.(設備產能依產品之型狀、材質及線材抗拉強度而有所差異。)
- THE KICK-OUT STROKE IN BRACKET SHOWS THE MAX. LENGTH OF THE PRODUCT ALLOWED FOR ROTATIONAL TRANSFER. (後托頂出長度括弧內之數據表示壓造過程中翻轉產品的最長長度)

16

JNFP SERIES 5&6 STATION NUT FORMER (五&六模螺帽成型機)

SPECIFICATION規格/機型	MODEL	JNFP 8B5S	JNFP 8B6S	JNFP 10B5S	JNFP 10B6S	JNFP 14B5S	JNFP 14B6S	JNFP 17B5S	JNFP 17B6S	JNFP 19B5S	JNFP 19B6S	JNFP 24B5S	JNFP 24B6S	JNFP 28B5S	JNFP 28B6S
FORGING STATION模數		5	6	5	6	5	6	5	6	5	6	5	6	5	6
CUT-OFF DIA. MAX. 最大切斷直徑 (mm)		8		10		14		17		21		26		28	
CUT-OFF LENGTH MAX. 最大切斷長度 (mm)		6		8		13		17		20		23		26	
KICK-OUT LENGTH MAX. 後托頂出長度 (mm)		10		13		15		20		25		30		35	
P.K.O. LENGTH MAX. 前托頂出長度 (mm)		6		7		8		10		12		14		16	
CUT-OFF QUILL(DxL) 切模 (mm)		28x 35		38x 45		45x 60		55x 68		65x 75		85x 90		94x 100	
MAIN DIE HOLE(DxL) 母模 (mm)		37x 45		45x 65		60x 75		75x 80		100x 100		115x 115		125x 125	
DIES PITCH母模中心距離 (mm)		48		57		72		87		111		129		138	
PUNCH HOLE(DxL) 公模束 (mm)		30x 58		37x 69		42x 86		55x 97		70x 110		80x 142		84x 160	
RAM STROKE主滑板行程 (mm)		70	70	80	80	90	90	110	110	120	120	140	140	160	160
FORGING POWER壓造力 (ton)		30	40	45	55	85	100	115	130	165	175	250	280	320	360
PRODUCT SIZE產品規格 (mm)		3/16(M5)	3/16(M5)	1/4(M6)	1/4(M6)	3/8(M8)	3/8(M8)	3/8(M10)	3/8(M10)	1/2(M12)	1/2(M12)	5/8(M16)	5/8(M16)	3/4(M18)	3/4(M18)
MAX. OUTPUT每分鐘最大產能 (pcs/minute)		380	360	340	330	280	260	240	225	190	180	160	150	135	125
MAIN MOTOR主馬達 (hp)		10	15	15	20	30	30	30	40	40	50	50	75	75	100
APPROX. WT. 機械重量 (ton)		5.3	6.2	7	9	13	15	16	19	21	24	39	43	52	58

P2-1

DSC09-0419-2016

- WE RESERVE THE RIGHT TO CHANGE THE DESIGNS & SPECIFICATIONS WITHOUT NOTICE(本公司隨時進行研究改進的工作，因此保有隨時更改設計、規格尺寸及機械結構之權利，本目錄僅供參考。)
- PRODUCTION CAPACITY DEPENDS ON APPLICABLE PRODUCTS, MATERIAL, TENSILE STRENGTH OF THE WIRE.(設備產能依產品之型狀、材質及線材抗拉強度而有所差異。)
- THE KICK-OUT STROKE IN BRACKET SHOWS THE MAX. LENGTH OF THE PRODUCT ALLOWED FOR ROTATIONAL TRANSFER. (後托頂出長度括弧內之數據表示壓造過程中翻轉產品的最長長度)

17

JNFP SERIES 5&6 STATION NUT FORMER (五&六模螺帽成型機)

SPECIFICATION規格/機型	MODEL	JNFP 32B5S	JNFP 32B6S	JNFP 36B5S	JNFP 36B6S	JNFP 38B5S	JNFP 38B6S	JNFP 41B5S	JNFP 41B6S	JNFP 45B5S	JNFP 45B6S			
FORGING STATION 模數		5	6	5	6	5	6	5	6	5	6			
CUT-OFF DIA. MAX. 最大切斷直徑 (mm)		33		36		38		41		45				
CUT-OFF LENGTH MAX. 最大切斷長度 (mm)		30		40		50		80		100				
KICK-OUT LENGTH MAX. 後托頂出長度 (mm)		40		50		60		100		105				
PK.O. LENGTH MAX. 前托頂出長度 (mm)		20		22		23		34		36				
CUT-OFF QUILL(DxL) 切模 (mm)		105x 120		115x 135		115x 135		132x 155		138x 165				
MAIN DIE HOLE(DxL) 母模 (mm)		150x 150		160x 165		166x 180		180x 240		195x 250				
DIES PITCH 母模中心距離 (mm)		165		174		180		195		210				
PUNCH HOLE(DxL) 公模束 (mm)		102x 182		102x 220		108x 250		120x 250		135x 250				
RAM STROKE 主滑板行程 (mm)		190		200		210		270		280				
FORGING POWER 壓造力 (ton)		420	480	550	600	620	700	740	800	850	900			
PRODUCT SIZE 產品規格 (mm)		7/8(M22)	7/8(M22)	1(M24)	1(M24)	1(M24)	1(M24)	1&1/8 (M27)	1&1/8 (M27)	1&1/4 (M30)	1&1/4 (M30)			
MAX OUTPUT 每分鐘最大產能 (pcs/minute)		100	90	85	80	75	70	65	60	55	50			
MAIN MOTOR 主馬達 (hp)		100	125	125	150	150	150	175	200	250	300			
APPROX. WT. 機械重量 (ton)		68	76	89	98	102	112	127	140	143	159			

P2-2

DSC09-0206-2015

- WE RESERVE THE RIGHT TO CHANGE THE DESIGNS & SPECIFICATIONS WITHOUT NOTICE(本公司隨時進行研究改進的工作，因此保有隨時更改設計、規格尺寸及機械結構之權利，本目錄僅供參考。)
- PRODUCTION CAPACITY DEPENDS ON APPLICABLE PRODUCTS, MATERIAL, TENSILE STRENGTH OF THE WIRE.(設備產能依產品之型狀、材質及線材抗拉強度而有所差異。)
- THE KICK-OUT STROKE IN BRACKET SHOWS THE MAX. LENGTH OF THE PRODUCT ALLOWED FOR ROTATIONAL TRANSFER. (後托頂出長度括弧內之數據表示壓造過程中翻轉產品的最長長度)

JNFPL SERIES 5&6 STATION LONG STROKE NUT FORMER (五&六模長衝程螺帽成型機)

SPECIFICATION規格/機型	MODEL	JNFP 8B5SL	JNFP 8B6SL	JNFP 10B5SL	JNFP 10B6SL	JNFP 14B5SL	JNFP 14B6SL	JNFP 17B5SL	JNFP 17B6SL	JNFP 19B5SL	JNFP 19B6SL	JNFP 24B5SL	JNFP 24B5SLX	JNFP 24B6SL
FORGING STATION 模數		5	6	5	6	5	6	5	6	5	6	5	5	6
CUT-OFF DIA. MAX. 最大切斷直徑 (mm)		8		10		14		17		21		26		
CUT-OFF LENGTH MAX. 最大切斷長度 (mm)		20		25		30		35		40		50	60	50
KICK-OUT LENGTH MAX. 後托頂出長度 (mm)		30		38		42		50		58		66	80	66
PK.O. LENGTH MAX. 前托頂出長度 (mm)		8		10		13		14		17		24	26	24
CUT-OFF QUILL(DxL) 切模 (mm)		28x 35		38x 45		45x 60		55x 68		65x 75		85x90		
MAIN DIE HOLE(DxL) 母模 (mm)		37x 65		45x 80		60x 100		75x 125		100x 140		115x160	115x200	115x160
DIES PITCH 母模中心距離 (mm)		48		57		72		87		111		129		
PUNCH HOLE(DxL) 公模束 (mm)		30x 83		37x 75		42x 86		55x 120		70x 110		80x160	80x180	80x160
RAM STROKE 主滑板行程 (mm)		90		100		120		140		165		200	240	200
FORGING POWER 壓造力 (ton)		30	35	45	50	90	105	115	130	165	175	250	280	280
PRODUCT SIZE 產品規格 (mm)		φ 8x20	φ 8x20	φ 10x30	φ 10x30	φ 14x35	φ 14x35	φ 17x45	φ 17x45	φ 20x50	φ 20x50	φ 24x55	φ 24x65	φ 24x55
MAX OUTPUT 每分鐘最大產能 (pcs/minute)		320	300	290	275	240	225	190	180	170	160	140	115	130
MAIN MOTOR 主馬達 (hp)		10	15	15	20	30	30	30	40	40	50	50	75	75
APPROX. WT. 機械重量 (ton)		6.3	7.3	8.5	10	14	16.5	19	22	25	27	43	46	47

P2-1

DSC10-0419-2016

- WE RESERVE THE RIGHT TO CHANGE THE DESIGNS & SPECIFICATIONS WITHOUT NOTICE(本公司隨時進行研究改進的工作，因此保有隨時更改設計、規格尺寸及機械結構之權利，本目錄僅供參考。)
- PRODUCTION CAPACITY DEPENDS ON APPLICABLE PRODUCTS, MATERIAL, TENSILE STRENGTH OF THE WIRE.(設備產能依產品之型狀、材質及線材抗拉強度而有所差異。)
- THE KICK-OUT STROKE IN BRACKET SHOWS THE MAX. LENGTH OF THE PRODUCT ALLOWED FOR ROTATIONAL TRANSFER. (後托頂出長度括弧內之數據表示壓造過程中翻轉產品的最長長度)

JNFPL SERIES 5&6 STATION LONG STROKE NUT FORMER (五&六模長衝程螺帽成型機)

SPECIFICATION規格/機型	MODEL	JNFP 28B5SL	JNFP 28B6SL	JNFP 32B5SL	JNFP 32B6SL	JNFP 36B5SL	JNFP 36B6SL	JNFP 38B5SL	JNFP 38B6SL	JNFP 41B5SL	JNFP 41B6SL	JNFP 45B5SL	JNFP 45B6SL
FORGING STATION 模數		5	6	5	6	5	6	5	6	5	6	5	6
CUT-OFF DIA. MAX. 最大切斷直徑 (mm)		28		33		36		38		41		45	
CUT-OFF LENGTH MAX. 最大切斷長度 (mm)		55		65		70		80		90		100	
KICK-OUT LENGTH MAX. 後托頂出長度 (mm)		75		85		95		100		110		120	
PK.O. LENGTH MAX. 前托頂出長度 (mm)		26		32		38		38		40		40	
CUT-OFF QUILL(DxL) 切模 (mm)		94x 100		105x 120		115 x135		115x 135		132x 155		138x 165	
MAIN DIE HOLE(DxL) 母模 (mm)		125x 175		150x 190		160 x220		166x 250		180x 280		195x 280	
DIES PITCH母模中心距離 (mm)		138		165		174		180		195		210	
PUNCH HOLE(DxL) 公模束 (mm)		84x 180		102x 170		102 x220		108x 250		120x 250		135x 250	
RAM STROKE主滑板行程 (mm)		240		260		300		300		320		320	
FORGING POWER壓造力 (ton)		330	360	460	500	560	600	650	700	750	800	850	900
PRODUCT SIZE產品規格 (mm)		φ 28x65	φ 28x65	φ 33x70	φ 33x70	φ 36x85	φ 36x85	φ 40x90	φ 40x90	φ 42x100	φ 42x100	φ 46x100	φ 46x100
MAX. OUTPUT每分鐘最大產能 (pcs/minute)		120	110	90	80	75	70	75	70	65	60	60	55
MAIN MOTOR主馬達 (hp)		75	100	100	125	150	150	150	150	175	200	250	300
APPROX. WT. 機械重量 (ton)		56	62	75	83	97	106	112	122	138	151	152	169

P2-2

DSC10-0206-2015

- WE RESERVE THE RIGHT TO CHANGE THE DESIGNS & SPECIFICATIONS WITHOUT NOTICE(本公司隨時進行研究改進的工作，因此保有隨時更改設計、規格尺寸及機械結構之權利，本目錄僅供參考。)
- PRODUCTION CAPACITY DEPENDS ON APPLICABLE PRODUCTS, MATERIAL, TENSILE STRENGTH OF THE WIRE.(設備產能依產品之型狀、材質及線材抗拉強度而有所差異。)
- THE KICK-OUT STROKE IN BRACKET SHOWS THE MAX. LENGTH OF THE PRODUCT ALLOWED FOR ROTATIONAL TRANSFER. (後托頂出長度括弧內之數據表示壓造過程中翻轉產品的最長長度)

20

JPF SERIES MULTIPLE STATION NUT PARTS FORMER (多模短衝程零件成型機)

SPECIFICATION規格/機型	MODEL	JPF 8B5S	JPF 8B6S	JPF 10B5S	JPF 10B6S	JPF 14B5S	JPF 14B6S	JPF 17B5S	JPF 17B6S	JPF 17B7S	JPF 19B5S	JPF 19B6S	JPF 24B5S	JPF 24B6S	JPF 28B5S	JPF 28B6S
FORGING STATION 模數		5	6	5	6	5	6	5	6	7	5	6	5	6	5	6
CUT-OFF DIA. MAX. 最大切斷直徑 (mm)		8		10		14		17			21		26		28	
CUT-OFF LENGTH 切斷長度 (mm)		4~ 20		5~ 25		7~ 30		8.5~35			10.5~ 40		13~ 50		14~ 55	
KICK-OUT LENGTH MAX. 後托頂出長度 (mm)		30 (15)		38 (20)		42 (25)		50(30)			58 (35)		66 (40)		75 (45)	
PK.O. LENGTH MAX. 前托頂出長度 (mm)		8		10		13		16			19		25		29	
CUT-OFF QUILL(DxL) 切模 (mm)		28x 35		38x 45		45x 60		55x68			65x 75		85x 90		94x 100	
MAIN DIE HOLE(DxL) 母模 (mm)		37x 75		45x 90		60x 100		75x125			100x 140		115x 160		125x 175	
DIES PITCH 母模中心距離 (mm)		48		57		72		87			111		129		138	
PUNCH HOLE(DxL) 公模束 (mm)		30x 84		37x 92		42x 120		55x139			70x 155.5		80x 185		84x 221	
RAM STROKE 主滑板行程 (mm)		90		100		120		140			165		200		240	
FORGING POWER 壓造力 (ton)		30	35	45	50	90	105	115	130	160	165	175	250	280	330	360
PRODUCT SIZE 產品規格 (mm)		φ 8x20	φ 8x20	φ 10x30	φ 10x30	φ 14x35	φ 14x35	φ 17x45	φ 17x45	φ 17x45	φ 20x50	φ 20x50	φ 24x55	φ 24x55	φ 28x65	φ 28x65
OPEN UPSET DIA. 頭部最大鍛粗直徑 (mm)		--		Φ16		Φ24		Φ19			Φ28		Φ30		Φ32	
MAX. OUTPUT每分鐘最大產能 (pcs/minute)		320	300	290	275	240	225	190	180	170	170	160	140	130	120	110
MAIN MOTOR 主馬達 (hp)		10	15	15	20	30	30	30	40	40	40	50	50	75	75	100
APPROX. WT. 機械重量 (ton)		7	7.8	9.5	10.5	14.5	17	19.5	22.5	26	26	29	44	48	58	64

P2-1

DSC13-0526-2017

- WE RESERVE THE RIGHT TO CHANGE THE DESIGNS & SPECIFICATIONS WITHOUT NOTICE(本公司隨時進行研究改進的工作，因此保有隨時更改設計、規格尺寸及機械結構之權利，本目錄僅供參考。)
- PRODUCTION CAPACITY DEPENDS ON APPLICABLE PRODUCTS, MATERIAL, TENSILE STRENGTH OF THE WIRE.(設備產能依產品之型狀、材質及線材抗拉強度而有所差異。)
- THE KICK-OUT STROKE IN BRACKET SHOWS THE MAX. LENGTH OF THE PRODUCT ALLOWED FOR ROTATIONAL TRANSFER. (後托頂出長度括弧內之數據表示壓造過程中翻轉產品的最長長度)

21

SPECIFICATION規格/機型	MODEL	JPF 32B5S	JPF 32B6S	JPF 36B3S	JPF 36B5S	JPF 36B6S	JPF 38B5S	JPF 38B6S	JPF 41B5SS	JPF 41B5S	JPF 41B6SS	JPF 41B6S	JPF 45B5S	JPF 45B6S
FORGING STATION 模數		5	6	3	5	6	5	6	5	5	6	6	5	6
CUT-OFF DIA. MAX. 最大切斷直徑 (mm)		33		36			38		41				45	
CUT-OFF LENGTH 切斷長度 (mm)		16.5~65		18~120	18~70	18~70	19~80		20.5~80				22.5~100	
KICK-OUT LENGTH MAX. 後托頂出長度 (mm)		85 (50)		90(60)			100 (70)		100(60)	115(70)	100(60)	115(70)	120 (80)	
PK.O. LENGTH MAX. 前托頂出長度 (mm)		32		36			38		35	40	35	40	42	
CUT-OFF QUILL(DxL) 切模 (mm)		105x 120		115x135			115x 135		132x 155				138x 165	
MAIN DIE HOLE(DxL) 母模 (mm)		150x 190		160x220			166x 260		180x240	180x280	180x240	180x280	195x 280	
DIES PITCH 母模中心距離 (mm)		165		174			180		195				210	
PUNCH HOLE(DxL) 公模束 (mm)		102x 268		102x275			108x 289		120x289	120x289	120x289	120x289	135x 289	
RAM STROKE 主滑板行程 (mm)		260		280			300		270	320	270	320	320	
FORGING POWER 壓造力 (ton)		460	500	480	560	600	650	700	670	750	720	800	830	900
PRODUCT SIZE 產品規格 (mm)		φ 33x70	φ 33x70	φ 36x80	φ 36x80	φ 36x80	φ 40x90	φ 40x90	φ 40x80	φ 44x100	φ 40x80	φ 44x100	1&1/4 (M30)	1&1/4 (M30)
OPEN UPSET DIA. 頭部最大鍛粗直徑 (mm)		Φ38		Φ51			--		Φ52				Φ62	
MAX. OUTPUT 每分鐘最大產能 (pcs/minute)		90	80	85	80	75	75	70	65	60	60	60	60	55
MAIN MOTOR 主馬達 (hp)		100	125	125	150	150	175	200	175	200	200	200	250	300
APPROX. WT. 機械重量 (ton)		77	85	85	99	108	114	124	135	140	146	153	155	172

P2-2

DSC13-0526-2017

- WE RESERVE THE RIGHT TO CHANGE THE DESIGNS & SPECIFICATIONS WITHOUT NOTICE (本公司隨時進行研究改進的工作，因此保有隨時更改設計、規格尺寸及機械結構之權利，本目錄僅供參考。)
- PRODUCTION CAPACITY DEPENDS ON APPLICABLE PRODUCTS, MATERIAL, TENSILE STRENGTH OF THE WIRE. (設備產能依產品之型狀、材質及線材抗拉強度而有所差異。)
- THE KICK-OUT STROKE IN BRACKET SHOWS THE MAX. LENGTH OF THE PRODUCT ALLOWED FOR ROTATIONAL TRANSFER. (後托頂出長度括弧內之數據表示壓造過程中翻轉產品的最長長度)

SPECIFICATION規格/機型	MODEL	JNP 7B5S	JNP 7B6S	JNP 10B5S	JNP 10B6S	JNP 13B5S	JNP 13B6S	JNP 13B7S	JNP 19B5S	JNP 19B6S	JNP 24B5S	JNP 24B6S	JNP 24B7S	JNP 30B5S	JNP 30B6S	JNP 30B7S
FORGING STATION 模數		5	6	5	6	5	6	7	5	6	5	6	7	5	6	7
CUT-OFF DIA. MAX. 最大切斷直徑 (mm)		7		10		16			22		26			30		
CUT-OFF LENGTH 切斷長度 (mm)		3.5~40		5~45		8~60			11~70		13~80			15~100		
KICK-OUT LENGTH MAX. 後托頂出長度 (mm)		40 (18)		45 (20)		70(40)			100 (50)		110(60)			125(80)		
P.K.O LENGTH MAX. 前托頂出長度 (mm)		10		10		16			20		25			32		
CUT-OFF QUILL (DxL) 切模 (mm)		24x 30		28x 46		50x60			70x 75		85x90			94x100		
MAIN DIE HOLE (DxL) 母模 (mm)		38x 80		50x 85		70x110			90x 140		100x160			125x210		
DIES PITCH 母模中心距離 (mm)		48		60		87			111		126			138		
PUNCH HOLE (DxL) 公模束 (mm)		32x 70		40x 85		50x93			65x 130		75x157			90x250		
RAM STROKE 主滑板行程 (mm)		100		100		140			176		200			250		
FORGING POWER 壓造力 (ton)		26	30	55	65	110	135	140	185	220	270	300	330	380	420	460
OPEN UPSET DIA. 頭部最大鍛粗直徑 (mm)		Φ14		JSΦ15 ISΦ20		JSΦ22 ISΦ26			Φ27		Φ29			Φ32		
MAX. OUTPUT 每分鐘最大產能 (pcs/minute)		255	240	230	220	190	170	160	160	150	120	115	110	100	95	90
MAIN MOTOR 主馬達 (hp)		10	10	15	20	30	40	40	50	60	100	100	100	125	125	125
APPROX. WT. 機械重量 (ton)		7.3	8.5	11	12.6	20	23	28	29	32	47	54	61	75	83	96

P2-1

DSC08-0526-2017

- WE RESERVE THE RIGHT TO CHANGE THE DESIGNS & SPECIFICATIONS WITHOUT NOTICE (本公司隨時進行研究改進的工作，因此保有隨時更改設計、規格尺寸及機械結構之權利，本目錄僅供參考。)
- PRODUCTION CAPACITY DEPENDS ON APPLICABLE PRODUCTS, MATERIAL, TENSILE STRENGTH OF THE WIRE. (設備產能依產品之型狀、材質及線材抗拉強度而有所差異。)
- THE KICK-OUT STROKE IN BRACKET SHOWS THE MAX. LENGTH OF THE PRODUCT ALLOWED FOR ROTATIONAL TRANSFER. (後托頂出長度括弧內之數據表示壓造過程中翻轉產品的最長長度)

JNP SERIES MULTIPLE STATION NUT PARTS FORMER (多模短衝程特殊零件成型機)

SPECIFICATION 規格 / 機型 MODEL	JNP 36B5S	JNP 36B6S	JNP 36B7S	JNP 41B5S	JNP 41B6S	JNP 45B5S	JNP 45B6S								
FORGING STATION 模數	5	6	7	5	6	5	6								
CUT-OFF DIA. MAX. 最大切斷直徑 (mm)	34			41		45									
CUT-OFF LENGTH 切斷長度 (mm)	17~140			20.5~160		22.5~180									
KICK-OUT LENGTH MAX. 後托頂出長度 (mm)	150(90)			160 (100)		180 (100)									
P.K.O LENGTH MAX. 前托頂出長度 (mm)	36			38		40									
CUT-OFF QUILL (DxL) 切模 (mm)	110x155			132x 155		138x 165									
MAIN DIE HOLE (DxL) 母模 (mm)	155x280			180x 300		195x 265									
DIES PITCH 母模中心距離 (mm)	174			195		210									
PUNCH HOLE (DxL) 公模束 (mm)	110x222			120x 250		135x 280									
RAM STROKE 主滑板行程 (mm)	280			300		320									
FORGING POWER 壓造力 (ton)	560	620	680	750	820	830	900								
OPEN UPSET DIA. 頭部最大鍛粗直徑 (mm)	Φ51			Φ52		Φ62									
MAX. OUTPUT 每分鐘最大產能 (pcs/minute)	80	75	70	60	60	60	55								
MAIN MOTOR 主馬達 (hp)	150	150	150	200	250	250	300								
APPROX. WT. 機械重量 (ton)	108	118	134	152	166	170	188								

P2-2

DSC08-0526-2017

- WE RESERVE THE RIGHT TO CHANGE THE DESIGNS & SPECIFICATIONS WITHOUT NOTICE (本公司隨時進行研究改進的工作，因此保有隨時更改設計、規格尺寸及機械結構之權利，本目錄僅供參考。)
- PRODUCTION CAPACITY DEPENDS ON APPLICABLE PRODUCTS, MATERIAL, TENSILE STRENGTH OF THE WIRE. (設備產能依產品之型狀、材質及線材抗拉強度而有所差異。)
- THE KICK-OUT STROKE IN BRACKET SHOWS THE MAX. LENGTH OF THE PRODUCT ALLOWED FOR ROTATIONAL TRANSFER. (後托頂出長度括弧內之數據表示壓造過程中翻轉產品的最長長度)

JBP SERIES MULTIPLE STATION BOLT PARTS FORMER (多模長衝程特殊零件成型機)

SPECIFICATION 規格 / 機型 MODEL	JBP 7B5S	JBP 7B6S	JBP 10B5S	JBP 10B6S	JBP 13B5S	JBP 13B5SL	JBP 13B6S	JBP 13B6SL	JBP 13B7S	JBP 19B5S	JBP 19B5SL	JBP 19B6S	JBP 19B6SL	JBP 19B7S				
FORGING STATION 模數	5	6	5	6	5	5	6	6	7	5	5	6	6	7				
CUT-OFF DIA. MAX. 最大切斷直徑 (mm)	7		10		16				18									
CUT-OFF LENGTH 切斷長度 (mm)	7~55		10~70		16~110	24~180	16~110	24~180	16~110	18~140	27~185	18~140	27~185	18~140				
KICK-OUT LENGTH MAX. 後托頂出長度 (mm)	50(25)	50(25)	60(30)	60(30)	85(50)	170(80)	85(50)	170(80)	100(50)	110(60)	160(80)	110(60)	160(80)	110(60)				
P.K.O. LENGTH MAX. 前托頂出長度 (mm)	10	10	12	12	22	30	22	30	27	27	32	27	32	27				
CUT-OFF QUILL (DxL) 切模 (mm)	24x 30		28x 55		50x80				60x100		70x100		60x100		70x100		60x100	
MAIN DIE HOLE (DxL) 母模 (mm)	38x 100		50x 130		70x150	70x190	70x150	70x190	75x150	90x175	100x245	90x175	100x245	90x175				
DIES PITCH 母模中心距離 (mm)	48		60		87				111									
PUNCH HOLE (DxL) 公模束 (mm)	32x 90		40x 112		50x132				65x150		75x191	65x150	75x191	65x150				
RAM STROKE 主滑板行程 (mm)	100	100	120	120	190	250	190	250	230	230	280	230	280	230				
FORGING POWER 壓造力 (ton)	26	30	55	65	110	120	135	150	145	185	185	220	230	265				
OPEN UPSET DIA. 頭部最大鍛粗直徑 (mm)	Φ14		Φ15		Φ22				Φ27									
MAX. OUTPUT 每分鐘最大產能 (pcs/minute)	240	240	220	200	170	160	165	150	150	140	130	135	125	130				
MAIN MOTOR 主馬達 (hp)	10	10	15	20	30	40	40	40	40	50	75	75	100	100				
APPROX. WT. 機械重量 (ton)	7.5	8.8	13	14.5	25	28	27.5	32	30	34	37	37	40	40				

P3-1

DSC05-0526-2017

- WE RESERVE THE RIGHT TO CHANGE THE DESIGNS & SPECIFICATIONS WITHOUT NOTICE (本公司隨時進行研究改進的工作，因此保有隨時更改設計、規格尺寸及機械結構之權利，本目錄僅供參考。)
- PRODUCTION CAPACITY DEPENDS ON APPLICABLE PRODUCTS, MATERIAL, TENSILE STRENGTH OF THE WIRE. (設備產能依產品之型狀、材質及線材抗拉強度而有所差異。)
- THE KICK-OUT STROKE IN BRACKET SHOWS THE MAX. LENGTH OF THE PRODUCT ALLOWED FOR ROTATIONAL TRANSFER. (後托頂出長度括弧內之數據表示壓造過程中翻轉產品的最長長度)

JBP SERIES MULTIPLE STATION BOLT PARTS FORMER (多模長衝程特殊零件成型機)

SPECIFICATION 規格 / 機型 MODEL	JBP 24B5S	JBP 24B5SL	JBP 24B5XL	JBP 24B6S	JBP 24B6S	JBP 24B6SL	JBP 24B6SXL	JBP 24B7S	JBP 30B5S	JBP 30B5SL	JBP 30B6S	JBP 30B6SL	JBP 30B7S
FORGING STATION 模數	5	5	5	6	6	6	6	7	5	5	6	6	7
CUT-OFF DIA. MAX. 最大切斷直徑 (mm)	23								30				
CUT-OFF LENGTH 切斷長度 (mm)	23~185	34.5~270	46~320	18~145	23~185	34.5~270	46~320	23~185	30~250	45~400	30~250	45~400	30~250
KICK-OUT LENGTH MAX. 後托頂出長度 (mm)	160(80)	230(110)	285(140)	130(60)	160(80)	230(110)	285(140)	160(80)	220(110)	325(150)	220(110)	325(150)	220(110)
P.K.O. LENGTH MAX. 前托頂出長度 (mm)	32	42	60	32	32	42	60	32	42	70	42	70	42
CUT-OFF QUILL(DxL) 切模 (mm)	75x100	75x100	75x120	65x80	75x100	75x100	75x120	75x100	95x120				
MAIN DIE HOLE(DxL) 母模 (mm)	108x200	108x300	108x330	110x280	108x200	108x300	108x330	108x200	125x280	125x400	125x280	125x400	125x280
DIES PITCH 母模中心距離 (mm)	126								138				
PUNCH HOLE(DxL) 公模束 (mm)	75x181	75x231	75x232	75x210	75x181	75x231	75x232	75x181	90x260	90x290	90x260	90x290	90x260
RAM STROKE 主滑板行程 (mm)	280	360	460	230	280	360	460	280	360	520	360	520	360
FORGING POWER 壓進力 (ton)	270	280	300	250	300	320	340	330	380	400	420	420	460
OPEN UPSET DIA. 頭部最大鍛粗直徑 (mm)	Φ29								Φ32				
MAX. OUTPUT 每分鐘最大產能 (pcs/minute)	110	100	80	120	105	90	70	100	90	70	85	70	70
MAIN MOTOR 主馬達 (hp)	100	100	100	100	100	125	125	125	125	125	125	150	150
APPROX. WT. 機械重量 (ton)	54	60	66	57	62	70	74	70	85	103	96	118	108

P3-2

DSC05-0526-2017

- WE RESERVE THE RIGHT TO CHANGE THE DESIGNS & SPECIFICATIONS WITHOUT NOTICE (本公司隨時進行研究改進的工作，因此保有隨時更改設計、規格尺寸及機械結構之權利，本目錄僅供參考。)
- PRODUCTION CAPACITY DEPENDS ON APPLICABLE PRODUCTS, MATERIAL, TENSILE STRENGTH OF THE WIRE. (設備產能依產品之型狀、材質及線材抗拉強度而有所差異。)
- THE KICK-OUT STROKE IN BRACKET SHOWS THE MAX. LENGTH OF THE PRODUCT ALLOWED FOR ROTATIONAL TRANSFER. (後托頂出長度括弧內之數據表示壓進過程中翻轉產品的最長長度)

26

JBP SERIES MULTIPLE STATION BOLT PARTS FORMER (多模長衝程特殊零件成型機)

SPECIFICATION 規格 / 機型 MODEL	JBP 36B5S	JBP 36B5SL	JBP 36B6S	JBP 36B6SL	JBP 36B6SXL	JBP 41B5S	JBP 41B5SL	JBP 41B6S	JBP 41B6SL	JBP 45B5S	JBP 45B6S
FORGING STATION 模數	5	5	6	6	6	5	5	6	6	5	6
CUT-OFF DIA. MAX. 最大切斷直徑 (mm)	34					41				45	
CUT-OFF LENGTH 切斷長度 (mm)	34~280	51~400	34~280	51~400	72~450	41~320	61.5~440	41~320	61.5~440	45~420	
KICK-OUT LENGTH MAX. 後托頂出長度 (mm)	260(120)	350(160)	260(120)	350(160)	405(180)	280(130)	400(180)	280(130)	400(180)	360(160)	360(160)
P.K.O. LENGTH MAX. 前托頂出長度 (mm)	45	70	45	70	100	50	100	50	100	80	80
CUT-OFF QUILL(DxL) 切模 (mm)	110x155					132x 155				138x 180	
MAIN DIE HOLE(DxL) 母模 (mm)	155x310	155x400	155x310	155x400	155x500	180x350	180x490	180x350	180x490	195x450	195x450
DIES PITCH 母模中心距離 (mm)	174					195				210	
PUNCH HOLE(DxL) 公模束 (mm)	110x242	110x290	110x242	110x290	110x350	120x250	120x340	120x250	120x340	135x300	135x300
RAM STROKE 主滑板行程 (mm)	400	520	400	520	610	440	600	440	600	580	580
FORGING POWER 壓進力 (ton)	560	600	620	660	720	750	800	820	850	850	930
OPEN UPSET DIA. 頭部最大鍛粗直徑 (mm)	Φ51					Φ52				Φ62	
MAX. OUTPUT 每分鐘最大產能 (pcs/minute)	75	60	70	60	55	55	50	55	50	45	45
MAIN MOTOR 主馬達 (hp)	150	175	175	175	200	200	250	250	250	250	300
APPROX. WT. 機械重量 (ton)	115	125	126	137	143	163	178	177	196	200	220

P3-3

DSC05-0526-2017

- WE RESERVE THE RIGHT TO CHANGE THE DESIGNS & SPECIFICATIONS WITHOUT NOTICE (本公司隨時進行研究改進的工作，因此保有隨時更改設計、規格尺寸及機械結構之權利，本目錄僅供參考。)
- PRODUCTION CAPACITY DEPENDS ON APPLICABLE PRODUCTS, MATERIAL, TENSILE STRENGTH OF THE WIRE. (設備產能依產品之型狀、材質及線材抗拉強度而有所差異。)
- THE KICK-OUT STROKE IN BRACKET SHOWS THE MAX. LENGTH OF THE PRODUCT ALLOWED FOR ROTATIONAL TRANSFER. (後托頂出長度括弧內之數據表示壓進過程中翻轉產品的最長長度)

27



markacivata makine
baęlantı elemanları



www.markacivatamakine.com



markacivata makine
baęlantı elemanları

"GÜÇLÜ ÇÖZÜM ORTAęINIZ"



/markacivata

www.markacivatamakine.com